

## Mechanical Dimensions

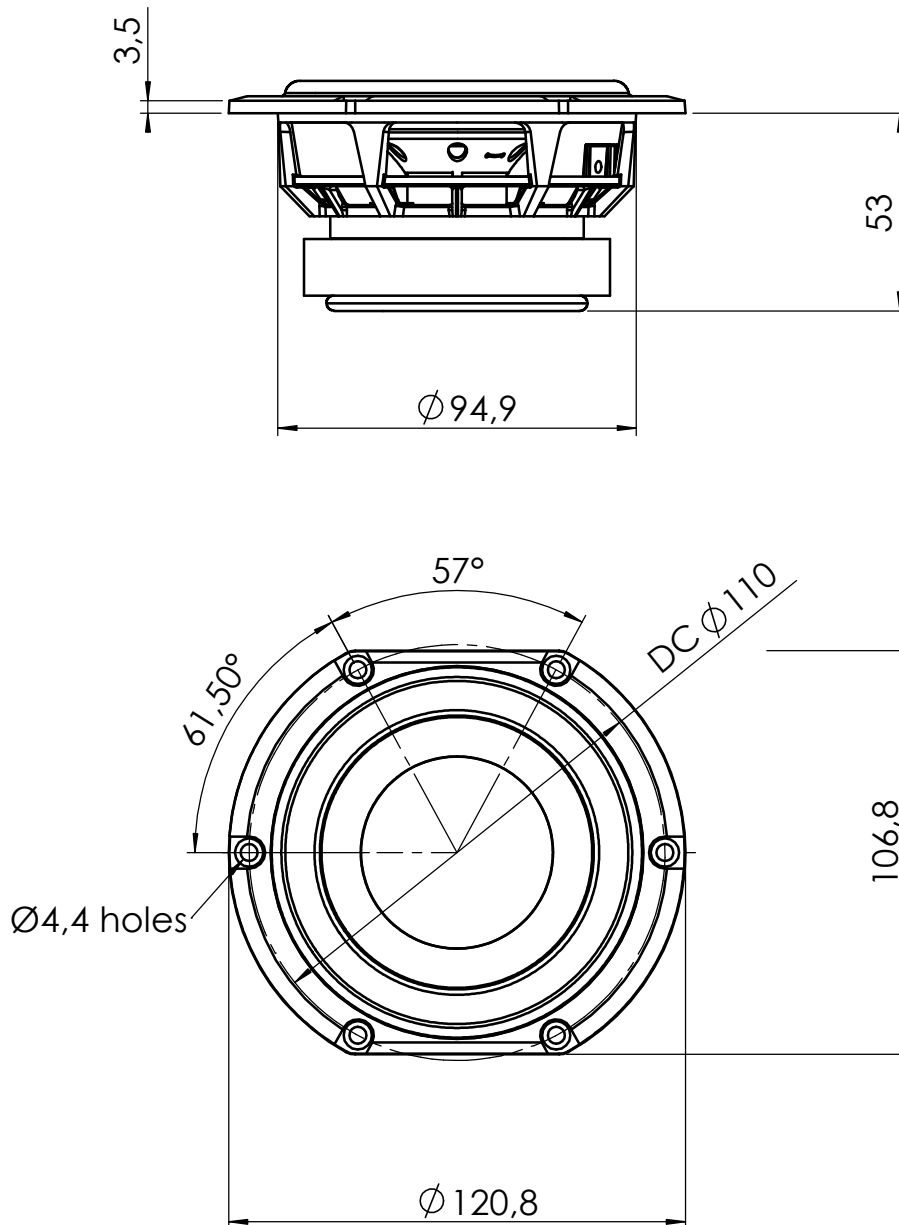

\* Dimensions listed are maximum production line values !

\* Recommended build in clearance : 0,5% of above values !

Drawing Scale **1:2** All dimensions are in millimeters !

The rights to make changes  
are reserved by DST A/S



Danish Sound Technology A/S  
Motorgangen 2-4, 2690 Karlslunde  
Tlf.: +045 7028 1700 Fax.: +45 4615 1171  
Website: [www.d-s-t.com](http://www.d-s-t.com)

**HDS 106 (Die Cast Aluminium)**

Order ID. **830870**

